

INSTALL FRONT WHEEL (ONE)

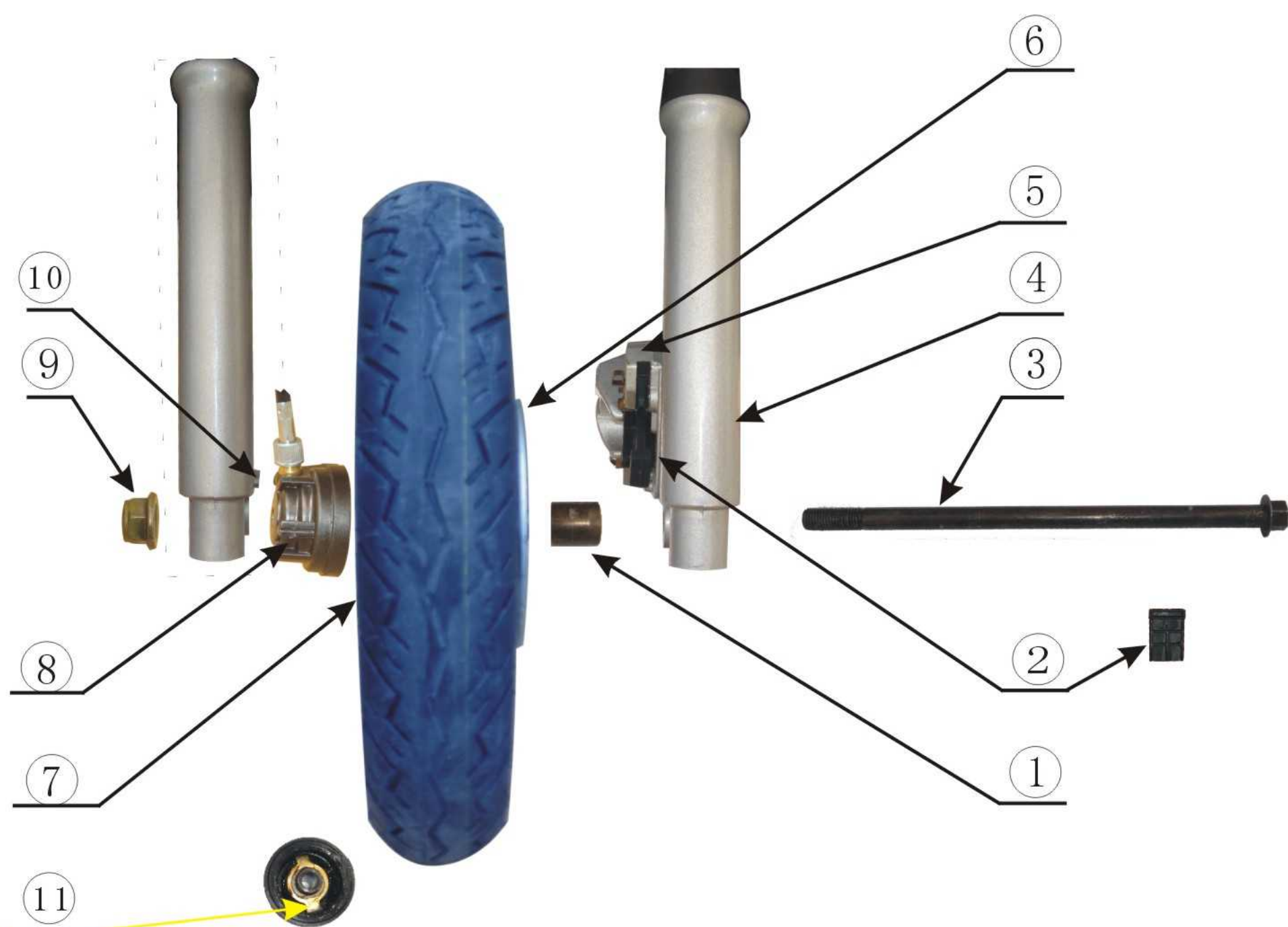

Description	Quantity	Specification	Remark
① FR Wheel Bush	1	∅ 10.5×∅ 19×21	Through front wheel axle
② Disc pad	1		Block in brake caliper
③ FR Wheel axle	1	M10×198	Fix in iron frame Packing
④ Left shock absorber	1		On motorcycle
⑤ Front disc brake	1		Install in left shock absorber
⑥ Brake Disc	1		Install in front wheel
⑦ Fr Wheel	1		In the Packing Box
⑧ Speedometer Gear	1		On motorcycle
⑨ Nut M14	1	M14*1.25	Fix in front axle Wheel
⑩ Right shock absorber	1		On motorcycle

Install step:

1. Take out ①, ③ and ⑨ from the iron frame packing
2. put ① into ⑦ and through middle of ⑦'s hole
3. connect ④, ①, ⑦, ⑧, ⑩ by ③ and fasten by ⑨

Attention:

1. take away ② from ⑤, and block ⑥ into ⑤
2. ⑪ which is in ⑧ must be put into the middle slot of ⑦, ⑩ must be locked in the slot of ⑧, referring the drawing.
3. ⑨ should be fixed by 13.5blf
4. running the front wheel clockwise to check whether it can be moved freely after installation, and to check whether the speedometer working properly

INSTALL HANDLEBAR (TWO)

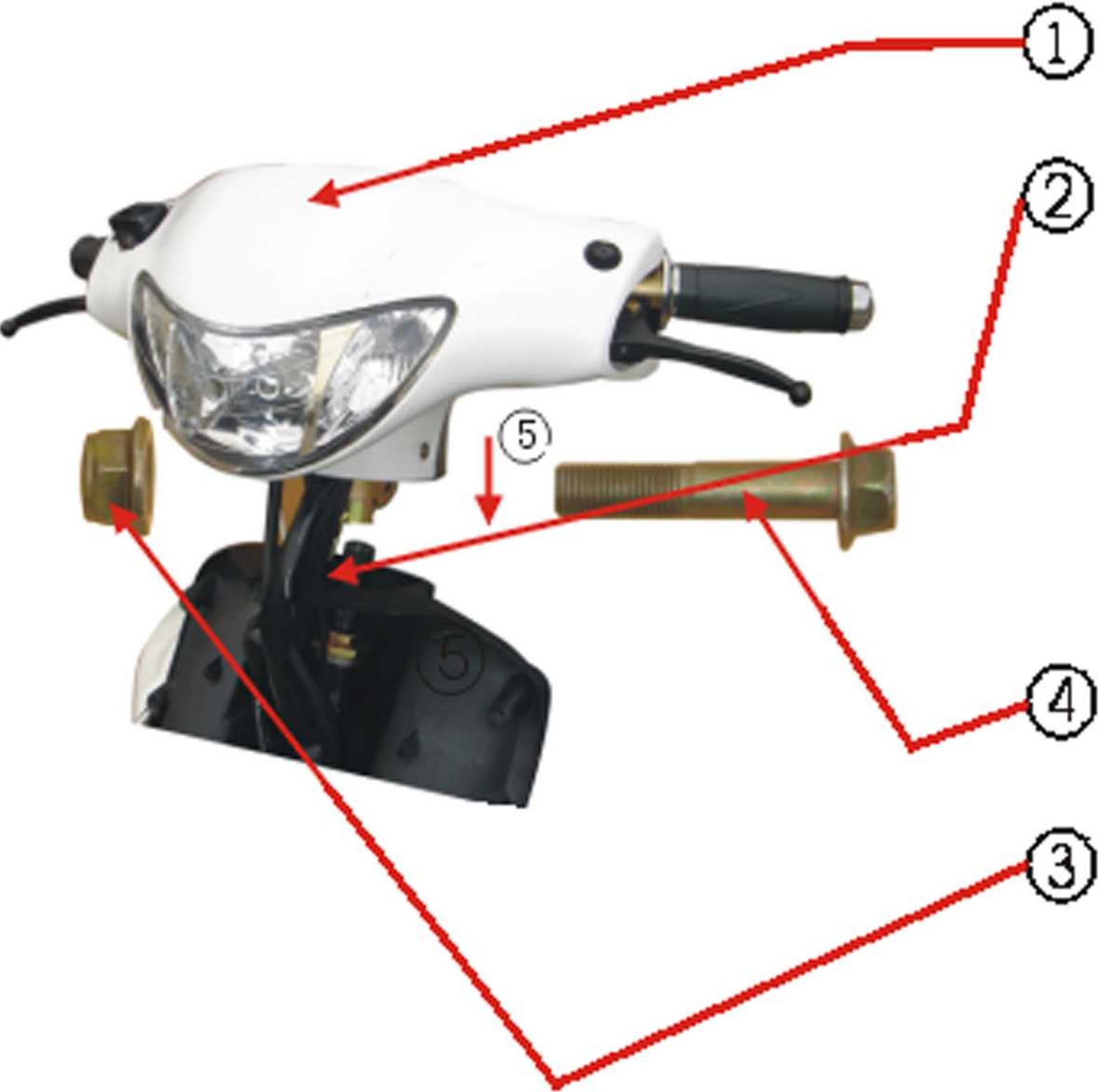

Description	Quantity	Specification	Remark	Twist power
① Steering handle	1		On motorcycle	
② Steering pole	1		On motorcycle	
③ Nut M14	1	M14×1.25	On motorcycle	20blf
④ Bolt M10*55	1		On motorcycle	
⑤ The way of assembiy	1		On motorcycle	

Install step:

- 1. Takedown ③ and ④ from steering handle
- 2. Put①on② according drawing's ⑤, notice outside of steering pole have guide track, and inside of steering handle have slot, insert against the guide track.
- 3. connect①,②by ④ , and fasten by ③

Attention:

- 1. connect ①,②by ④,④ through②'s pointed slot.
- 2. After installation, lift up the steering handle, check and sure without any gap .

INSTALL FRONT COVER (THREE)

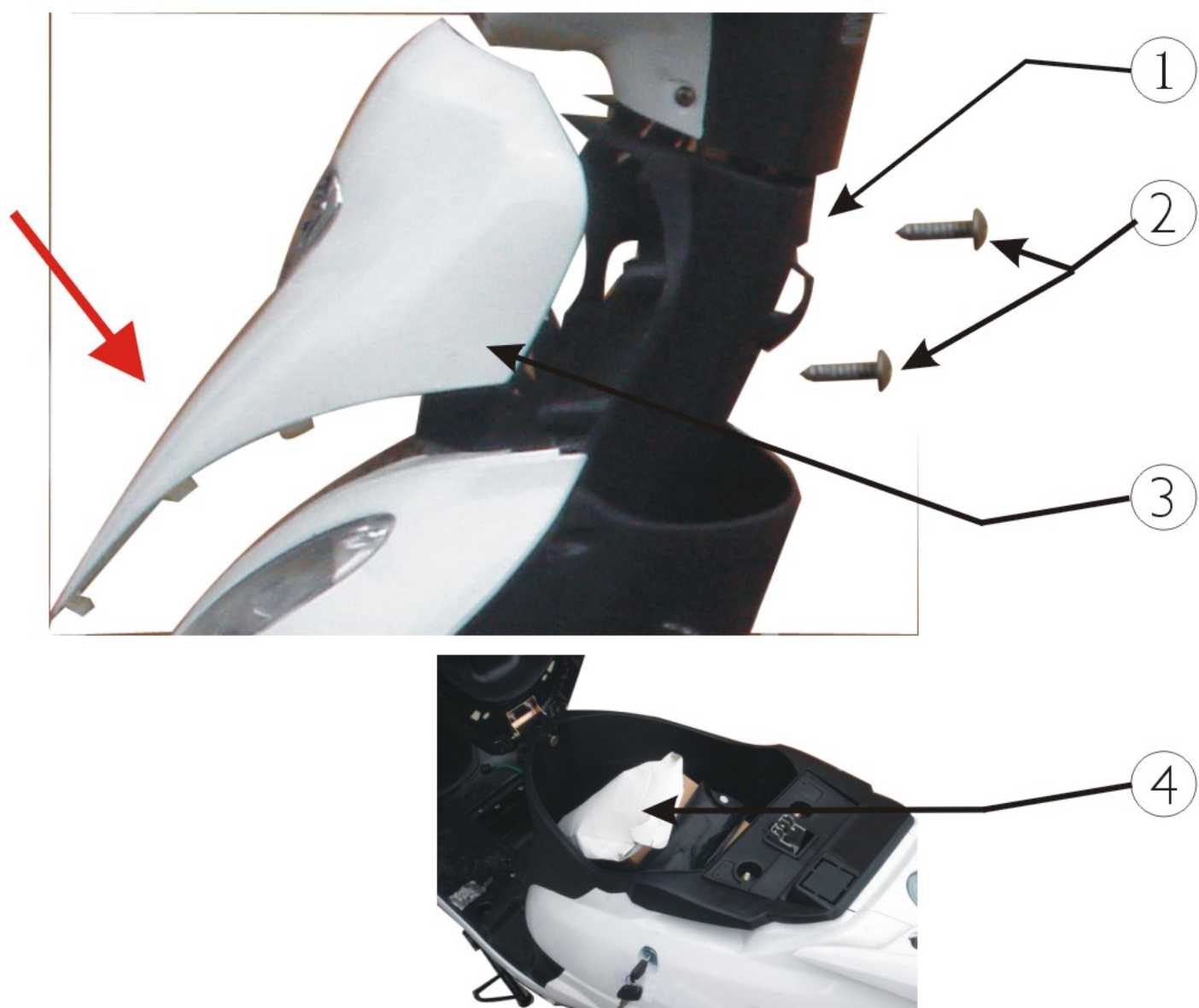

Description	Quantity	Specification	Remark
① Body	1		On motorcycle
② Self-tapped Screw	2		In sundries box
③ Front cover	1		On motorcycle
④ Sundries Box	1		

Install step:

1. refer drawing, Put ③ on ①
2. fasten ①, ③ by ②.

Attention:

1. Put ③ into ① as drawing, ③ must insert ①' slot. Pay attention to the clip of ③, and make sure all clips insert ①' slot, then push up ③, make sure the connection with ① very well.

INSTALL REARVIEW MIRROR (FOUR)



Description	Quantity	Specification	Remark
⑤ Rearview mirror	2		In sundries box
⑥ Front of motorcycle	1		On motorcycle

Install step:

1. Fix ⑤ on ⑥, by ⑤' s nut, and fasten well, before fastening, adjust the point view of of rearview mirror.

INSTALL BATTERY (FIVE)

Description	Quantity	Specification	Remark
① Battery sealed strip	1		In sundries box
② Electrolyte	1		In sundries box
③ Battery	1		In sundries box
④ Battery line	1		In sundries box
⑤ Battery Bolt	2		In sundries box
⑥ Battery Nut	2		In sundries box
⑦ Battery Cover Screw	3		On Motorcycle
⑧ Battery Cover	1		In sundries box

Install step:

1. inject ② into ③, refer the instruction of battery then cover ①.
2. Put ③ into battery box , connect electrode ④ by ⑤ and ⑥ fasten them
3. Take down ⑦ from vehicle , cover ⑧ and tighen by ⑦

Attention:

1. When you connect the electrode ④, make sure red line connect "+" anode , and green line connect "-" cathode
2. After installing battery, and inject electrolyte , then leave it for thirty minutes, then charge it

